



Principal applications

Designed for continuous re-circulation of carbonated water, aggressive chemicals, chilled water, pure or precious liquids in high pressure systems

Features

Manufactured in chemical resistant thermoplastics

Operating at an optimum flow rate of 3 litres/minute

Magnetic couplings provide an energy efficient thermal shield,
minimising heat transfer to pumped fluids

Temperature stability & product purity ensured

Leak free continuous operation

Drip proof IP22 motor housing

Low condensation

Nitrile 'O' rings standard. Other materials available

Zero maintenance

PPS pump head

Long life

HPR 6/8

230V 1ph 50/60Hz

110V 1ph 50/60Hz

Port Details

½" or 15mm od

½" or 15mm od

Threaded port option available



Drawings not to scale
 Dimensions in millimetres

HPR6/8

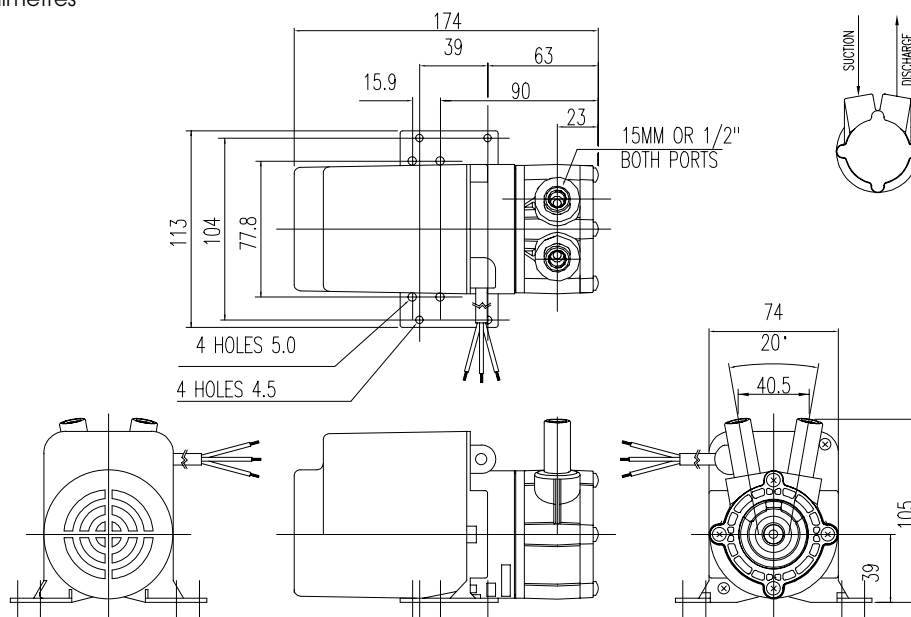

Specification

Model	Overall height mm	Overall length mm	Overall width mm	Weight kilos	Max body pressure bar	Max capacity litres/min	Max head metres	Temp range °c	*Max specific gravity	Motor output Watts
HPR 6/8	105	174	113	1.2	10	5.5	7.4	-20° to +85°	1.2	18

*assuming maximum viscosity Of 30cp. Refer to the Company for higher viscosities & specific gravities

Performance Tested with clean cold water @ 20° c

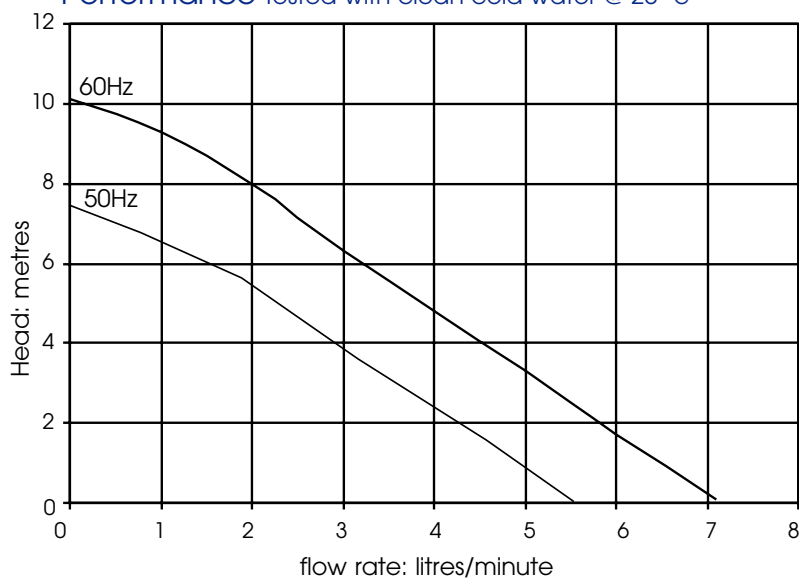

NOTE: These magnetically coupled pumps are designed for use with clean fluids. Solids will cause jamming. Abrasives will reduce pump life & invalidate the warranty. HPR pumps are not self-priming & are not designed to run dry.

The company reserves the right to change specifications

a division of *the* Electric Motor Company Limited

phone+44 (0)23 8066 6685

fax+44 (0)23 8066 6880

email: info@totton-pumps.com

www. toffon-pumps.co.uk